

Bayonet 5 pin female

Mounting instruction Bayonet 5 pin female

Bayonet 5 pin

Bayonet 5 pin

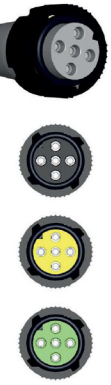
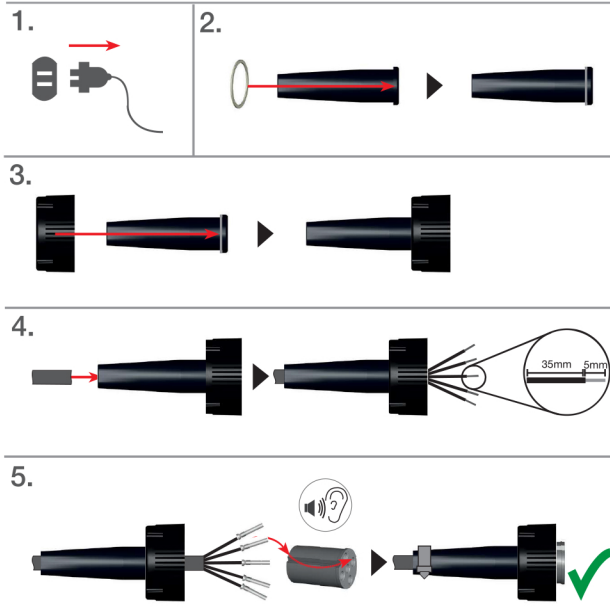
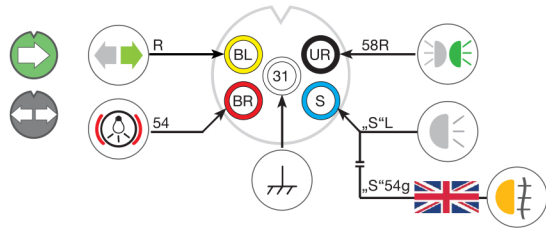
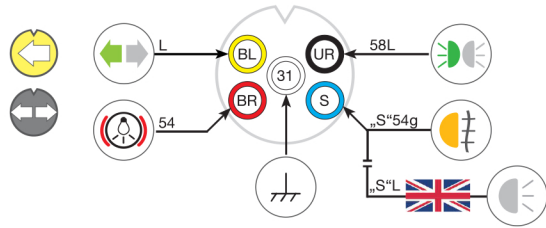
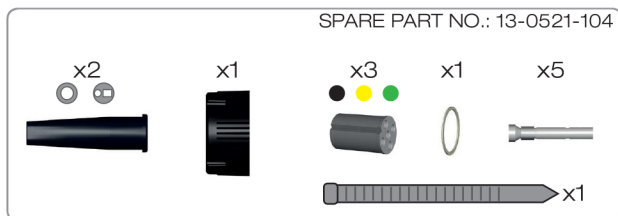

Imax=16A



Imax=16A



ASS1, ASS2, ASS2.1 7 pin female

Mounting instruction ASS1, ASS2 7 pin female

ASS1, ASS2, ASS2.1, 7 pin

ASS1, ASS2, ASS2.1, 7 pin

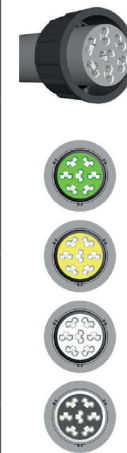
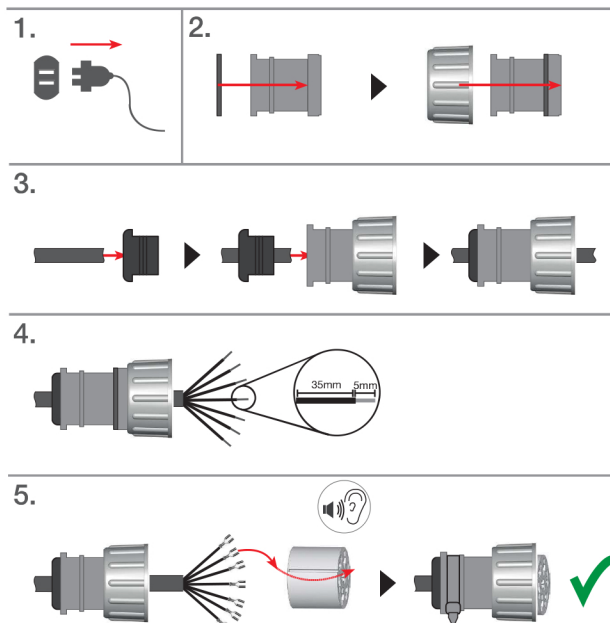
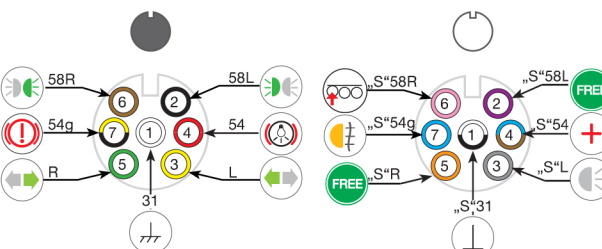
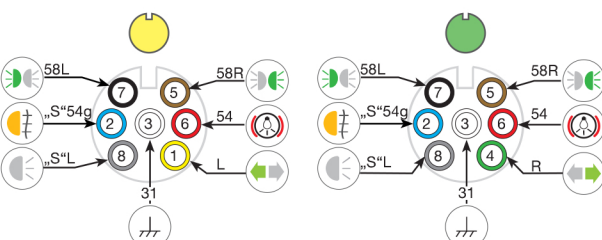
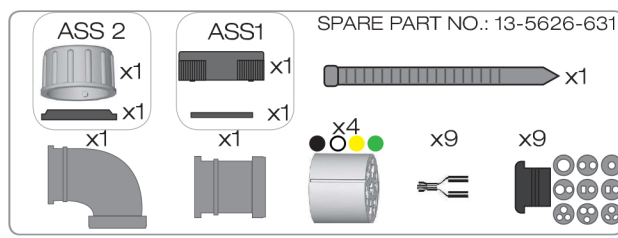

Imax=25A



Imax=25A

